



SERIES 'O' PLASTIC SUMP PUMP

MODEL OL75V

PARTS LIST
PP-8975A
DEC. 1998

Refer to Bulletin PP-310, Operation and Service Guide PO-907
and Master Price List PF-1075.

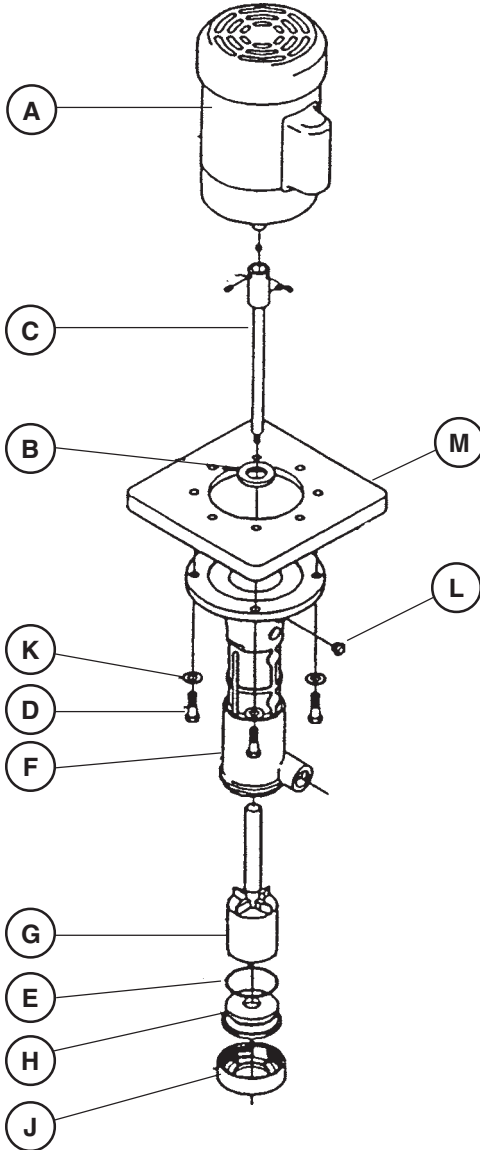

ITEM	DESCRIPTION	PART NUMBER	
		115-230V/1/60	230-460V/3/60
A	Motor-TEFC, 56C 1/3 HP 1/2 HP For 110-220V/1/50 or 220-380-440V/3/50 motor, add -5 to Part Number	62-1219 62-1226	62-1689 62-1230
B	Fume barrier - Teflon	62-8121 TF	
C	Shaft w/ setscrews - stn. steel Includes: Setscrew HD (1 req'd) Setscrew cup (3 req'd)	62-8101 1 62-0566 62-0567	
D	Bolt 3/8"-16 x 1 1/2"-SS (4 req'd)	62-3148	
E	Suction "O"-ring - Viton (std.) - EPDM (opt)	62-8122 VN 62-8122 EP	
F ¹	Body, round flange	62-8282	
G ¹	Impeller (2.25" dia.)	62-8115	
H ¹	Suction cover	62-8100	
J ¹	Suction retainer	62-8102	
K	Washer, 3/8"- stn. steel (4 req'd)	62-3081	
L	Plug, weep hole (2 req'd)	62-8124	
M ²	Mounting plate	62-8129	

¹ Add 'CP', 'PP', or 'PF' to part number to specify material.

² Add 'CP' or 'PP' to part number to specify material.

See Flow Chart on back page.

